

# MACARTHUR COMMONS



MACARTHUR BART, 40TH & TELEGRAPH, OAKLAND, CA 94609



\*Rendering Source: Hines



## LOCKEHOUSE

**CHRIS HOMS**

(650) 548-2687

[chris@lockehouse.com](mailto:chris@lockehouse.com)

License #01901922

**BRENDAN WALSH**

(650) 400-7010

[brendan@lockehouse.com](mailto:brendan@lockehouse.com)

License #01801511



# MACARTHUR COMMONS

A trio of distinctive new apartment buildings across from Oakland's MacArthur BART station. Sleek and modern with a retro vibe, MacArthur Commons provides the only significant retail offering with new Class A retail space in one of the Bay Area's most connected locations.



## VIBRANT TEMESCAL

Known for its eclectic vibe, craft stores and great food, Temescal serves up a new surprise on every block. Join the community of retailers creating a unique sense of place in this historic neighborhood



## A NEW MEETING PLACE

Urban Density:  $\pm 800$  apartments under construction on this block  
Outdoor plaza, called "The Mews" carefully designed to connect buildings and create community  
28,000 SF of Retail space with up to 28 commercial parking stalls



## CONNECTED TO IT ALL

Convenient to multiple Bay Area work centers including San Francisco, Emeryville, Downtown Oakland, Uptown, and UC Berkeley  
Adjacent to one of the busiest BART stations in Oakland with over 4,044 riders daily

# LEASEABLE SPACES

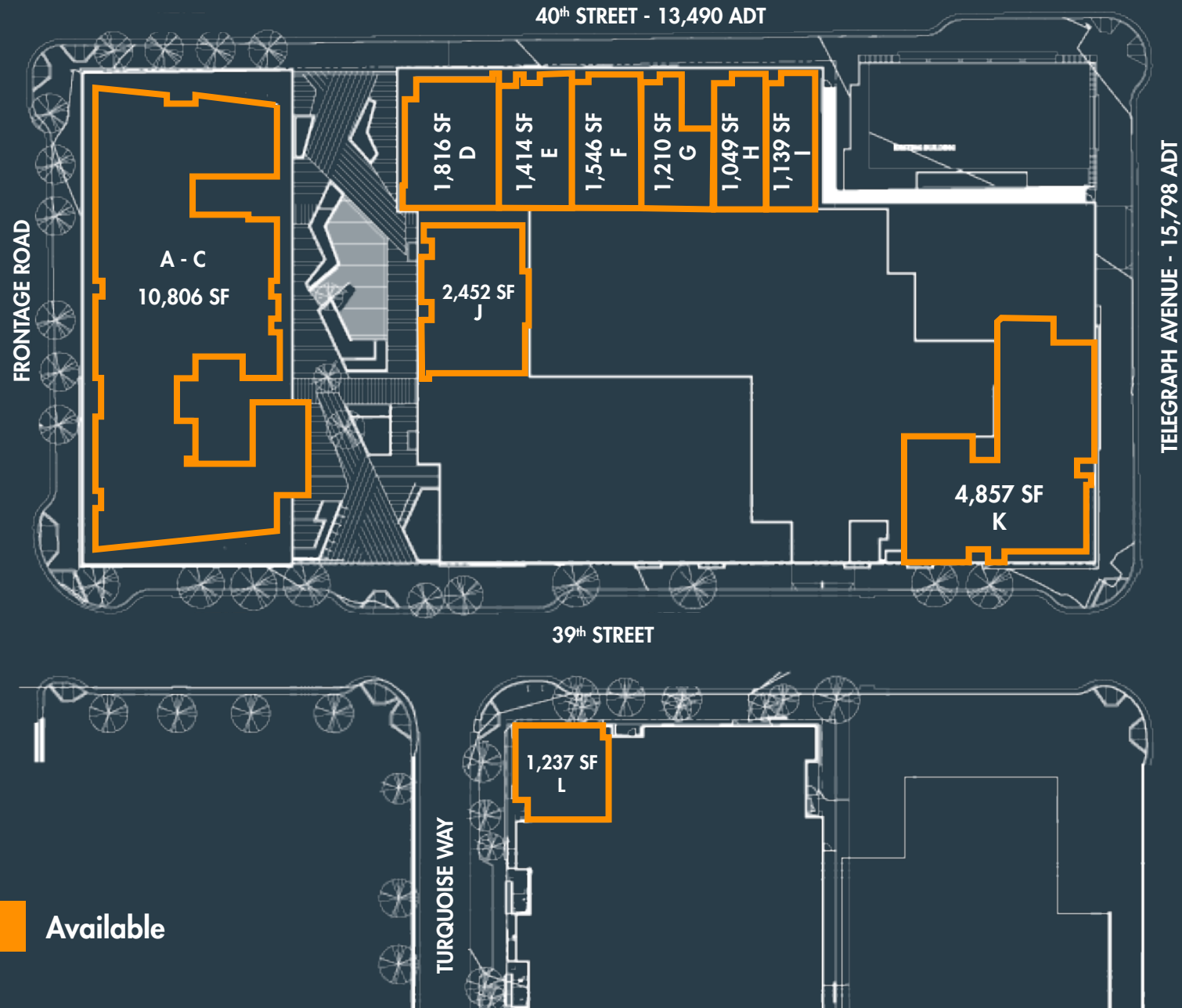



# MARKET AERIAL

MACARTHUR COMMONS





# TEMESCAL

Telegraph Ave is the vibrant heart of Oakland's historic Temescal neighborhood. Known for its eclectic vibe, craft stores and great food, Temescal serves up a new surprise on every block—places to eat, shop, grab a coffee or raise a glass. You'll find craft breweries, handmade jewelry, art classes, and galleries, along these walkable, tree-lined streets. There's an unmistakable energy here, an entrepreneurial spirit that's both engaging and inspiring.

“

Like downtown Oakland, the Temescal District, on Telegraph Avenue, came alive because of its eclectic restaurant scene, such as the immensely popular Bakesale Betty's and a collection of diverse eateries such as Asmara Restaurant, Burma East, Cafe Eritrea D'Afrique and Homeroom Mac & Cheese. With that came businesses that reflect Oakland's diverse and artistic culture.

”

SFGate, June 2017







# LOCKEHOUSE

**CHRIS HOMS**

(650) 548-2687  
chris@lockehouse.com  
License #01901922

**BRENDAN WALSH**

(650) 400-7010  
brendan@lockehouse.com  
License #01801511