

1,609 SF AVAILABLE - LAST REMAINING SPACE

THE DEPOT @ TRESTLE

555 & 661 EL CAMINO REAL | SAN CARLOS, CA 94070

Welcoming:



&



OUT OF THE BARREL
TAPROOM



LOCKEHOUSE

2099 Mt. Diablo Blvd., Suite 206,
Walnut Creek, CA 94596
License #01784084

BRENDAN WALSH

650-400-7010
brendan@lockehouse.com
License #02140273

CHRIS HOMS

650-548-2687
chris@lockehouse.com
License #01901922

PROPERTY HIGHLIGHTS

555 & 661 El Camino Real | San Carlos

- 555 El Camino Real: 1,609 SF
- Ideally Located at the San Carlos CalTrain Depot
- Steps from Downtown San Carlos
- High Traffic on El Camino Real at 31,000 ADT
- On-Site Parking Available
- Tremendous Visibility on El Camino Real



LOCKEHOUSE

2099 Mt. Diablo Blvd., Suite 206,
Walnut Creek, CA 94596
License #01784084

BRENDAN WALSH

650-400-7010
brendan@lockehouse.com
License #02140273

CHRIS HOMS

650-548-2687
chris@lockehouse.com
License #01901922

INTERIOR PHOTOS

555 & 661 El Camino Real | San Carlos



LOCKEHOUSE

2099 Mt. Diablo Blvd., Suite 206,
Walnut Creek, CA 94596
License #01784084

BRENDAN WALSH

650-400-7010
brendan@lockehouse.com
License #02140273

CHRIS HOMS

650-548-2687
chris@lockehouse.com
License #01901922

GROUND FLOOR RETAIL FLOOR PLANS

555 & 661 El Camino Real | San Carlos

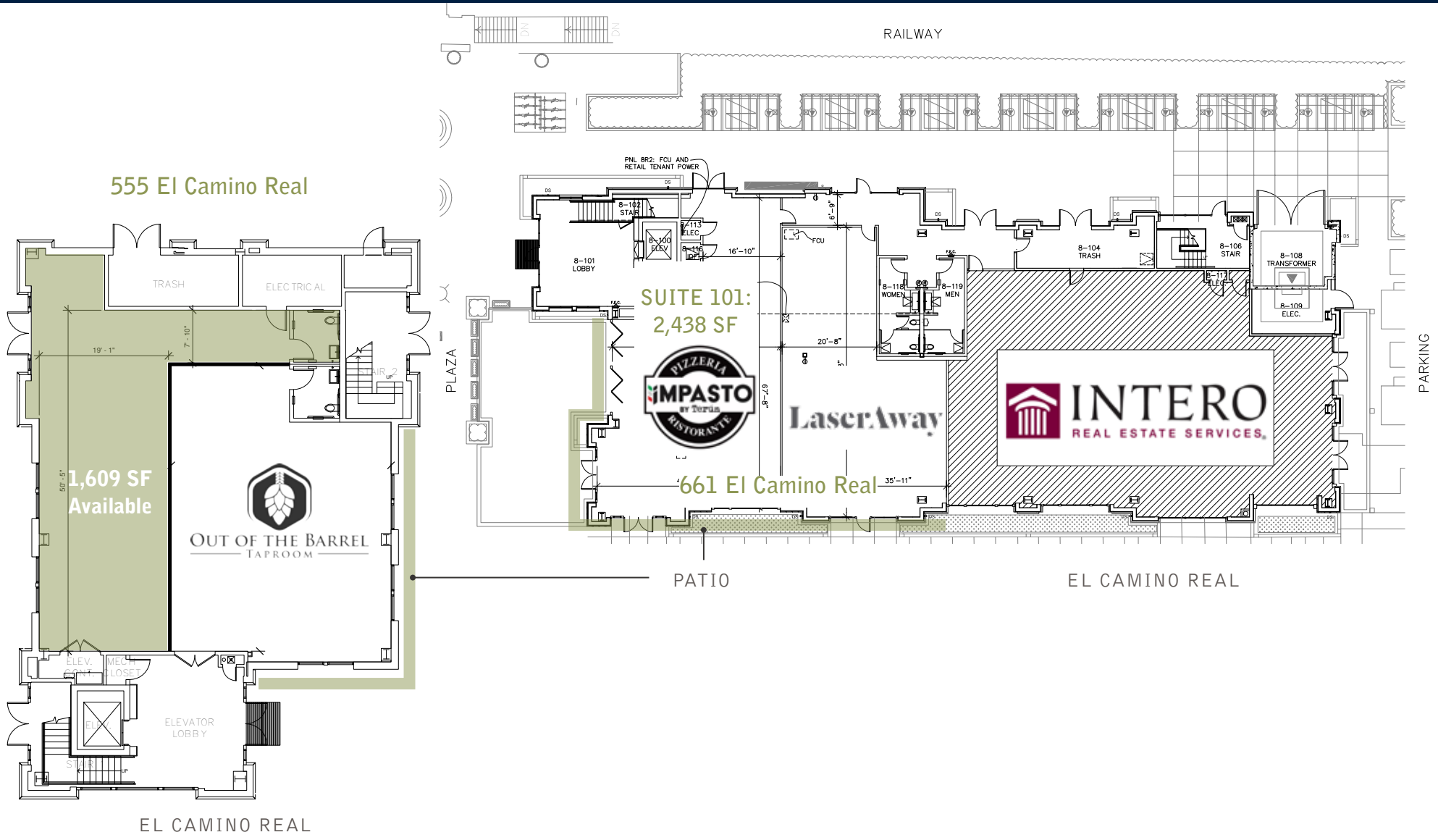

LOCKEHOUSE

2099 Mt. Diablo Blvd., Suite 206,
Walnut Creek, CA 94596
License #01784084

BRENDAN WALSH

650-400-7010
brendan@lockehouse.com
License #02140273

CHRIS HOMS

650-548-2687
chris@lockehouse.com
License #01901922



LOCKEHOUSE

2099 Mt. Diablo Blvd., Suite 206,
Walnut Creek, CA 94596
License #01784084

BRENDAN WALSH

650-400-7010
brendan@lockehouse.com
License #02140273

CHRIS HOMS

650-548-2687
chris@lockehouse.com
License #01901922



*Traffic Counts Source: Sites USA REGIS Online 1/31/24



LOCKEHOUSE

2099 Mt. Diablo Blvd., Suite 206,
Walnut Creek, CA 94596
License #01784084

BRENDAN WALSH

650-400-7010
brendan@lockehouse.com
License #02140273

CHRIS HOMS

650-548-2687
chris@lockehouse.com
License #01901922