



# Premier South San Francisco Development

988 El Camino Real, South San Francisco, CA

Prime Retail Space Available For Lease Now



## Recently Signed Leases



Starbird



OPTICA  
OPTOMETRY

solidaritus

# LOCKEHOUSE

2099 Mt. Diablo Blvd., Suite 206  
Walnut Creek, CA 94596  
License #01784084

**Chris Homs**  
(650) 548-2687  
Chris@lockehouse.com  
License #01901922

**Brendan Walsh**  
(925) 627-4272  
Brendan@lockehouse.com  
License #02140273



# PROPERTY HIGHLIGHTS

988 El Camino Real, South San Francisco, CA

2 |



- 1,404 SF of Retail Available
- Approximately  $\pm 39$  at Grade Parking Stalls Available ( $\pm 4/1,000$ )
- Surrounded by Dense Residential - Near Office and Medical
- Located Directly off El Camino Real & HWY 280
- Under 1 Mile from South San Francisco BART Station
- 3M+ SF of Nearby Retail Within 3 Miles: Serramonte Center, Westlake Center, Gellert Marketplace, 280 Metro Center and Serra Center



# SITE PLAN

988 El Camino Real, South San Francisco, CA



- Suite 1:** 610 SF
  - Suite 2:** Leased
  - Suite 3:** 794 SF
  - Suite 4:** Leased
  - Suite 5:** Leased
  - Suite 6:** Leased
  - Suite 7:** 827 SF
  - Suite 8:** Leased
  - Suite 9:** Leased
- Retail Parking: ±39 Stalls (±4/1,000)**
  - Available Retail Space**
  - Leased**
  - In Lease**
  - Pedestrian Path to Parking**
  - ← Vehicle Access to Parking**

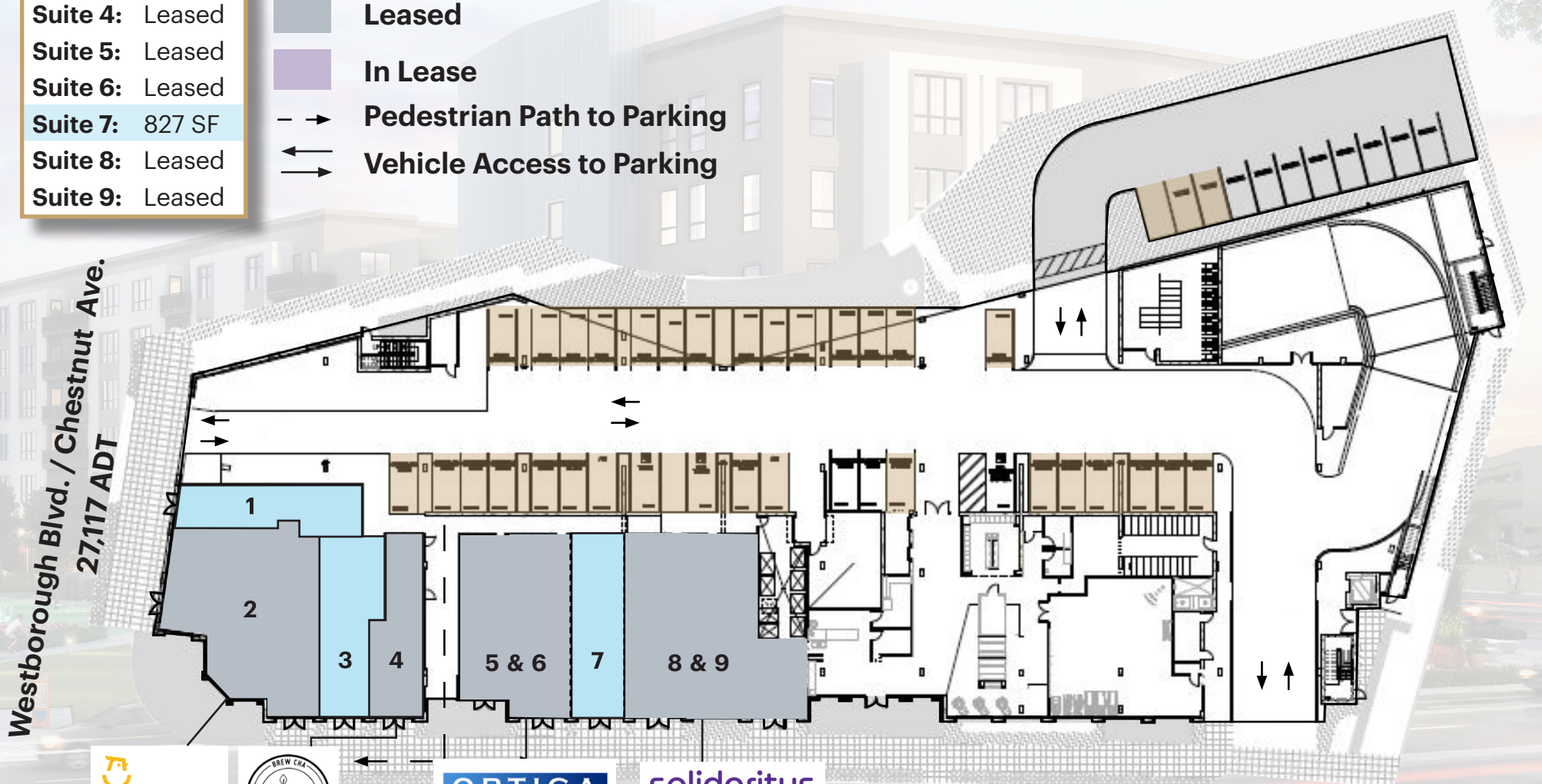

Westborough Blvd. / Chestnut Ave.  
27,117 ADT



El Camino Real - 37,392 ADT

\*Traffic Counts Source: Site USA REGIS 11/3/23



# MARKET AERIAL

988 El Camino Real, South San Francisco, CA

4 |



**280 METRO CENTER**

THE HOME DEPOT PRO	Ashley HOMESTORE	SHOE DEPT.
ROSS DRESS FOR LESS	Office DEPOT	Marshalls

**SERRA CENTER**

TARGET	Michaels Where Creativity Happens	BevMo!
--------	-----------------------------------	--------

**SERRAMONTE CENTER**

macy's	ROSS DRESS FOR LESS
DICK'S SPORTING GOODS	DAVE & BUSTERS
WORLD MARKET	TJ-maxx
TARGET	SHOE PALACE

**GELLERT MARKETPLACE**

SPROUTS FARMERS MARKET	BED BATH & BEYOND
Total Wine & MORE	PET SMART

**SAN BRUNO TOWNE CENTER**

Lucky	LOWE'S Home Improvement Warehouse	DXL DESTINATION XL
Marshalls	BevMo!	CHUCK E. CHEESE'S

**BAYHILL SHOPPING CENTER**

CVS pharmacy	ACE Hardware	MOLLIE STONE'S
--------------	--------------	----------------

**THE SHOPS AT TANFORAN**

CENTURY THEATRES	TARGET	petco
jcpenny	BevMo!	CHUCK E. CHEESE'S

\*Traffic Counts Source: Site USA REGIS 11/3/23



# DEMOGRAPHICS

988 El Camino Real, South San Francisco, CA

5 |

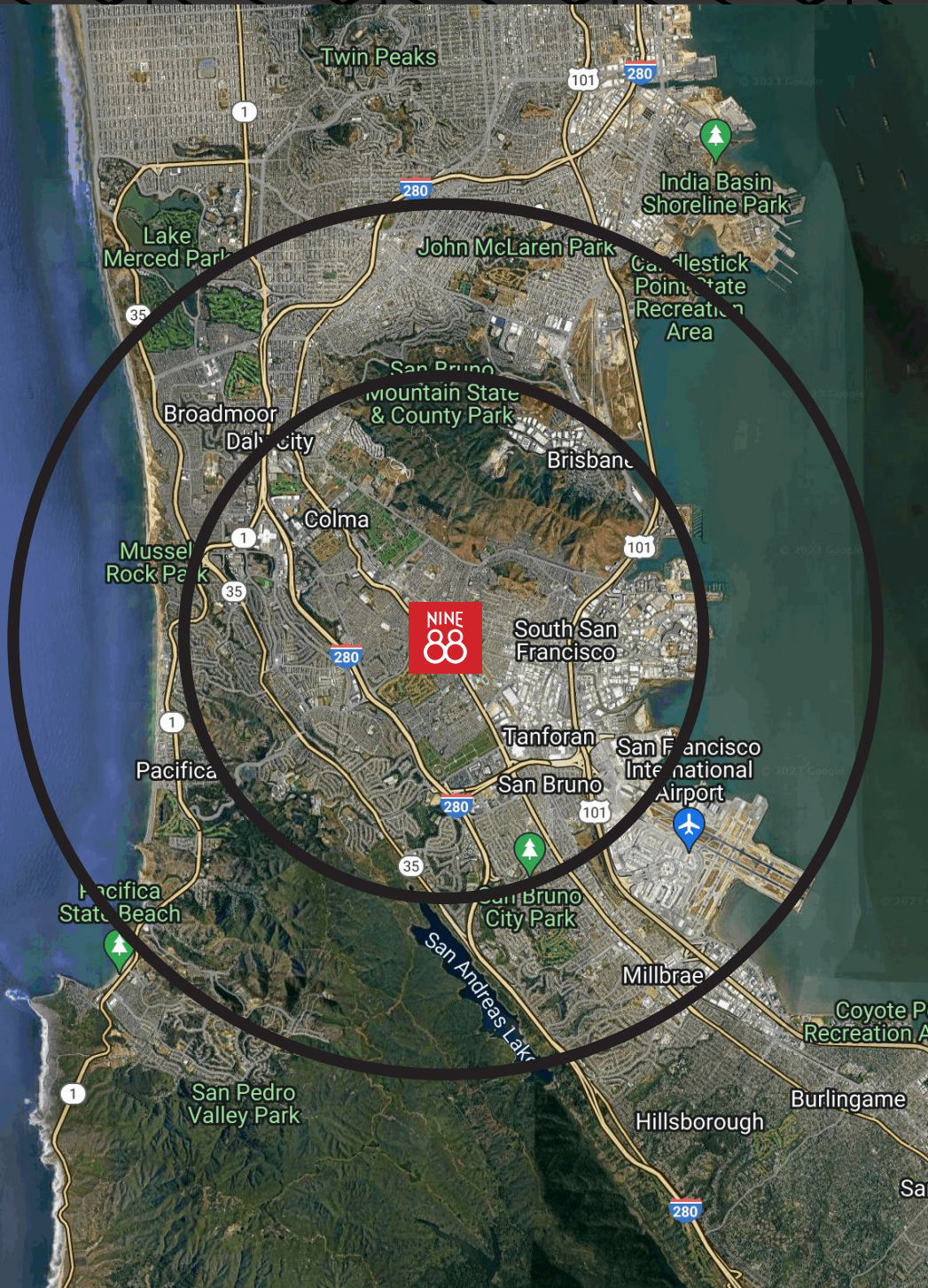

3 MILES	5 MILES
151,060	370,157

**ESTIMATED POPULATION**



3 MILES	5 MILES
72,000	112,867

**DAYTIME EMPLOYEES**



3 MILES	5 MILES
\$183,218	\$183,432

**AVERAGE HOUSEHOLD INCOME**



3 MILES	5 MILES
41.2%	40.2%

**BACHELOR'S DEGREE OR HIGHER**



3 MILES	5 MILES
\$2.67 B	\$6.14 B

**HOUSEHOLD RETAIL EXPENDITURES**



3 MILES	5 MILES
33.0%	34.2%

**HOUSEHOLDS WITH CHILDREN**



3 MILES	5 MILES
61.3%	61.7%

**HOME VALUES OVER 1 MILLION**



\*Demographics Source: Site USA REGIS 11/3/23