



*Photo Source: CoStar.com

6,000 - 12,000 SF Available (Divisible)

SHUM PLAZA

2743-2745 S. EL CAMINO REAL
SAN MATEO, CALIFORNIA

RETAIL SPACE AVAILABLE



LOCKEHOUSE

LOCATION DESCRIPTION

Located on an extremely visible and accessible El Camino Real corner, the project offers exceptional positioning for a strong retailer. The space conveniently sits two blocks from Hillsdale Mall, one of the Peninsula's oldest and strongest regional shopping centers. It is also walking distance to CalTrain as well as Big 5 Sporting Goods, Bank of America, Fieldwork Brewing Co., and Roam Artisan Burgers. Accessible via Hwy 280 via and/or Hwy 101, the site is very transit-oriented and will only benefit from the surrounding office and retail developments.



PROPERTY PROFILE

AVAILABLE SPACE	6,000 - 12,000 SF (can be split or demised)
TRAFFIC COUNT	S. El Camino Real 34,174 ADT 28th Ave. 7,501 ADT
ASKING RENT	\$48.00/SF
NNN EXPENSES	\$10.68/SF
TERMS	Available for Short and Long Term Lease
PROPERTY HIGHLIGHTS	<ul style="list-style-type: none"> • Retail Space Located on Extremely Visible Portion of El Camino Real • Located Adjacent to the Newly Created E. 28th Ave. Thoroughfare • Free Rent/TI Available with Strong Credit • Ample Parking in Project • 1 Minute Walk to CalTrain



S. EL CAMINO REAL - 34,174 ADT

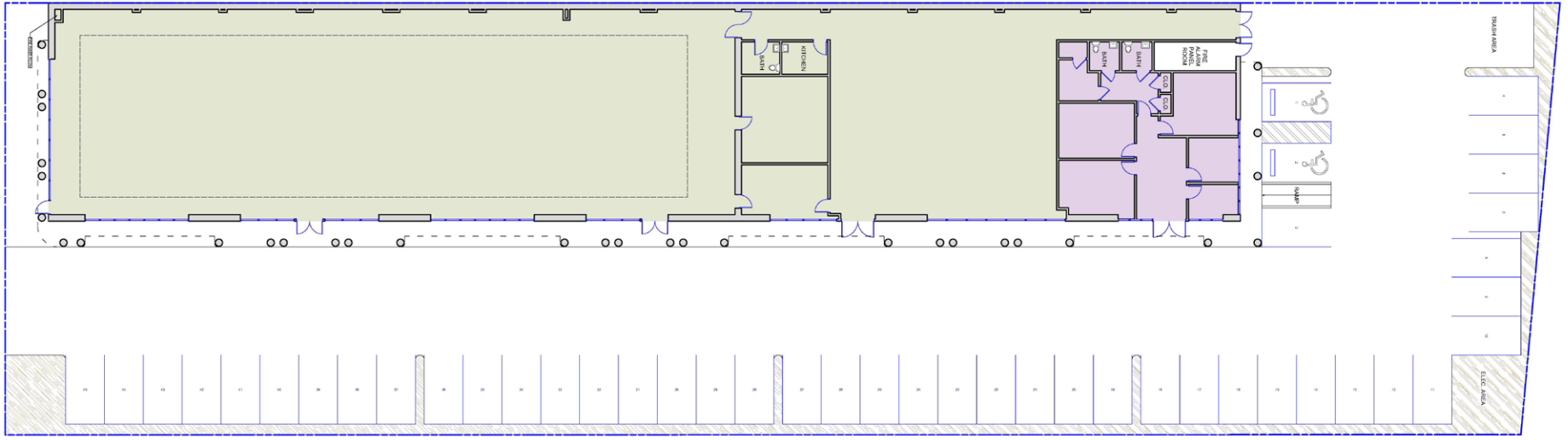

E. 28th Ave. - 7,501 ADT

PROPERTY PHOTOS



MARKET AERIAL

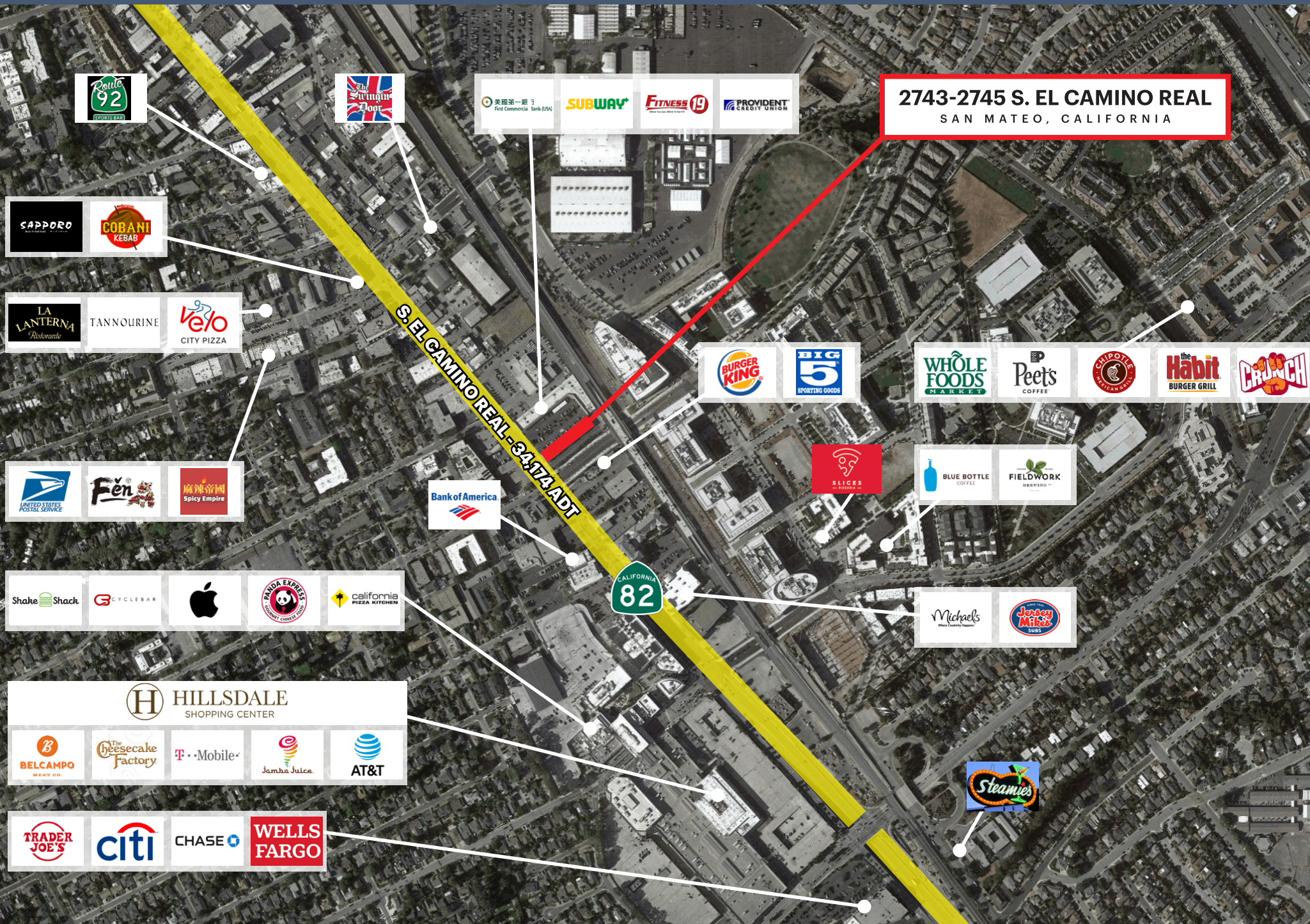

CLOSE UP AERIAL



2743-2745 S. EL CAMINO REAL
SAN MATEO, CALIFORNIA



S. EL CAMINO REAL - 34,174 ADT

27TH AVE.

28TH AVE. - 7,501 ADT



DEMOGRAPHICS



POPULATION

1 MILE	3 MILES	5 MILES
26,728	168,973	243,011



ESTIMATED AVERAGE HOUSEHOLD INCOME

1 MILE	3 MILES	5 MILES
\$194,004	\$218,838	\$232,374



HOUSEHOLD INCOME DISTRIBUTION

1 MILE	3 MILES	5 MILES
3,561	24,078	36,620



MEDIAN HOME VALUE \$1,000,000 or More

1 MILE	3 MILES	5 MILES
4,887	37,065	55,077



COLLEGE DEGREE BACHELOR DEGREE OR HIGHER

1 MILE	3 MILES	5 MILES
61.6%	64.7%	66.4%



TOTAL RETAIL EXPENDITURES

1 MILE	3 MILES	5 MILES
\$562.02 M	\$3.86 B	\$5.9 B





LOCKEHOUSE

CHRIS HOMS

(650) 548-2687

chris@lockehouse.com

License #01901922

BRENDAN WALSH

(650) 400-7010

brendan@lockehouse.com

License #02140273