

FOR LEASE

PRIME DOWNTOWN STOREFRONT

733 STATE
STREET
SANTA BARBARA, CA



LOCKEHOUSE

A MEMBER OF
CHAINLINKS
RETAIL ADVISORS

CONTACT US (805) 684-7767

Mike Hieshima
mike@lockehouse.com
License #00994298

Natalie V. Wagner
natalie@lockehouse.com
License #01868161

Theri Ramirez
theri@lockehouse.com
License #01942664

SUMMARY & HIGHLIGHTS

Located in the heart of Santa Barbara's Downtown corridor, this newly remodeled space offers approx. 40' of State Street frontage, great natural light, and is within close proximity to synergistic retailers such as Starbucks, Banana Republic, Bluemercury, lululemon, and more. Excellent location for a retailer or downtown creative office space.

SUMMARY

ADDRESS	733 State St., Santa Barbara, CA 93101
SIZE	±6,158 SF
CEILING HEIGHT	±12.9 Feet
HVAC	Throughout
PARKING	Adjacent to Abundant Structure Parking
RESTROOMS	Two (2) ADA
ASKING RATE	\$3.50/SF
NNN	Est. \$0.58/SF
AVAILABLE	October 2023

HIGHLIGHTS

- Heart of Downtown Santa Barbara Retail Corridor
- Approx. 40 Feet of State Street Frontage
- Over 1,900 City Parking Spaces within a 2-Block Radius
- Located at the Entrance to Paseo Nuevo and Adjacent to Banana Republic



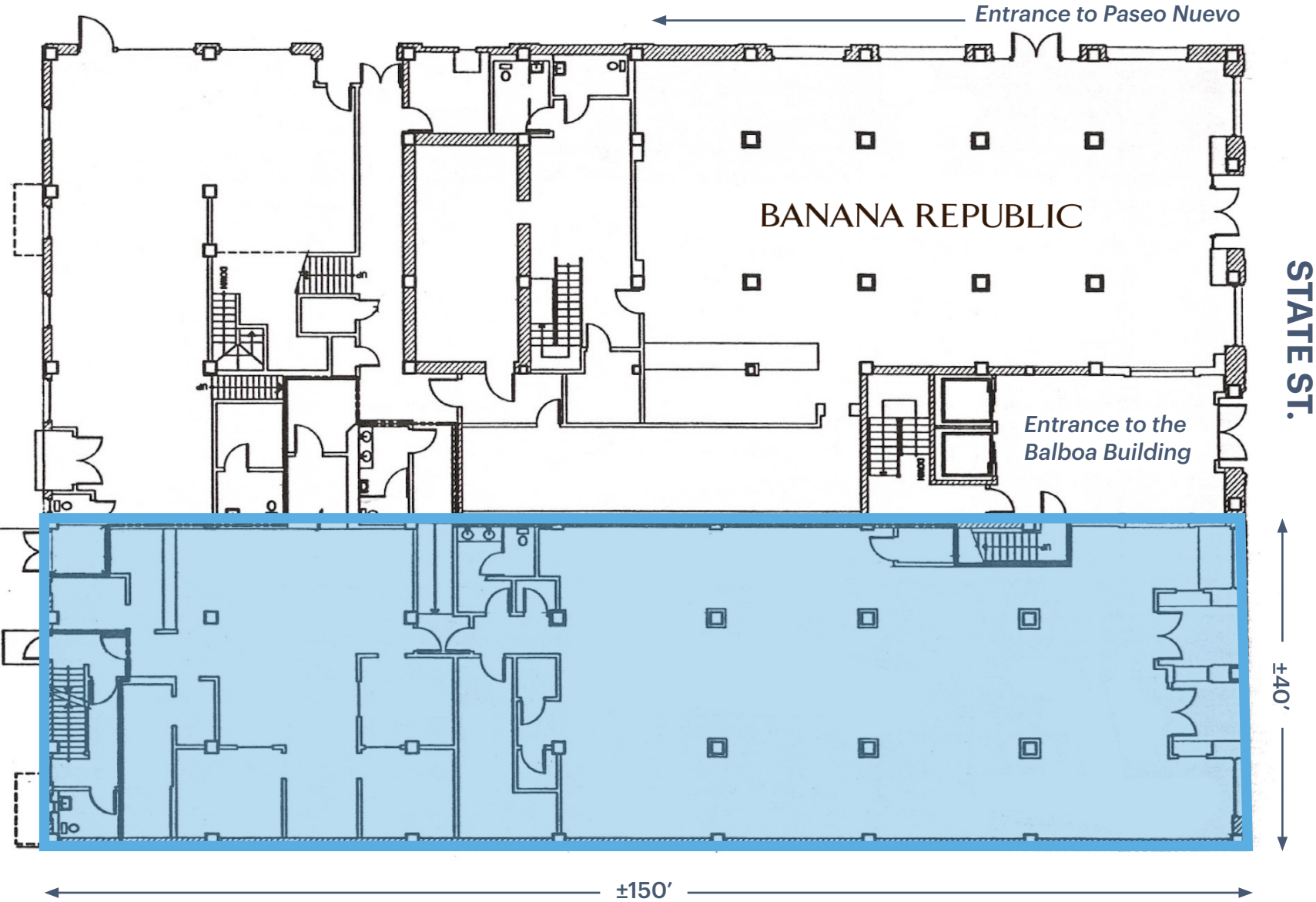

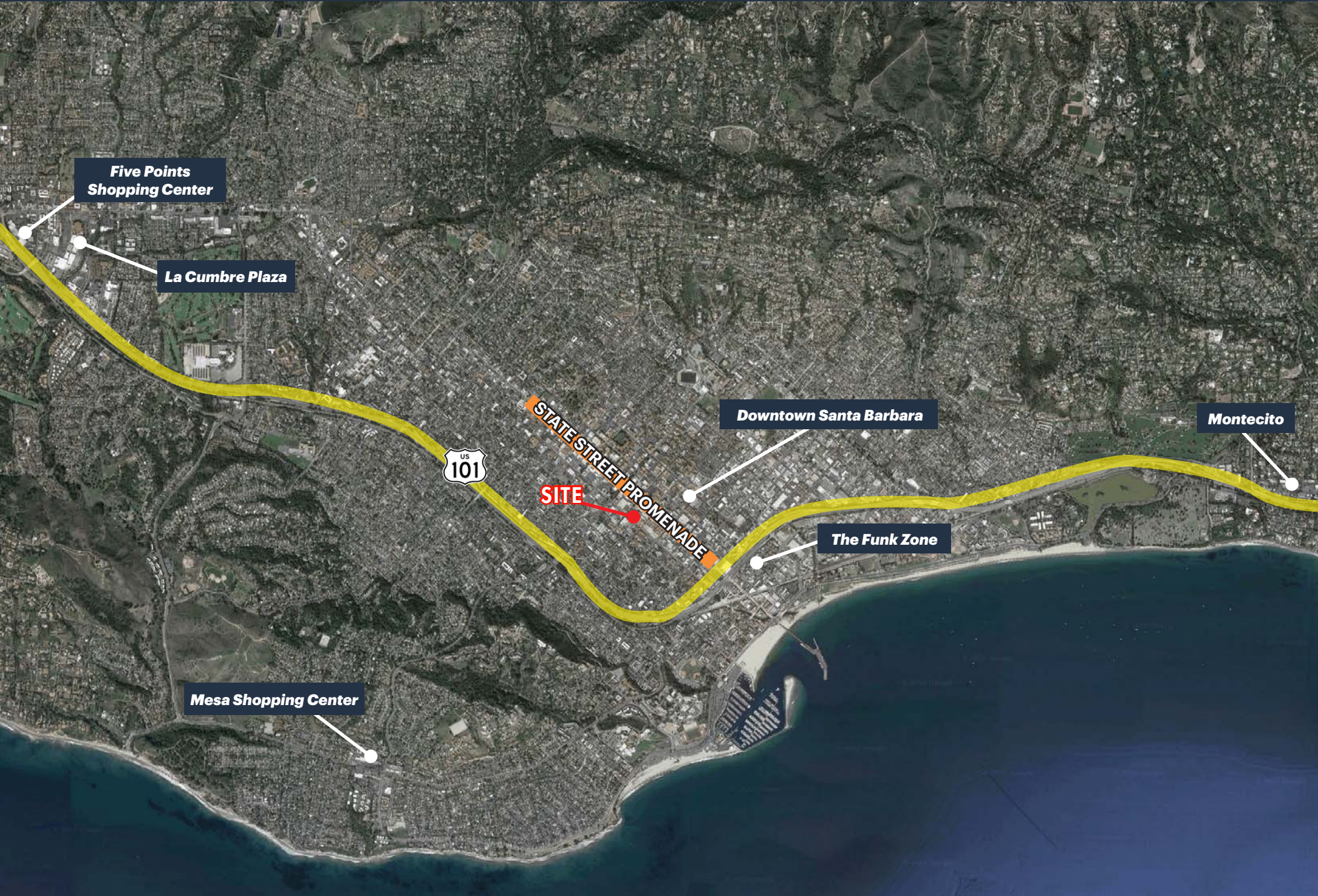

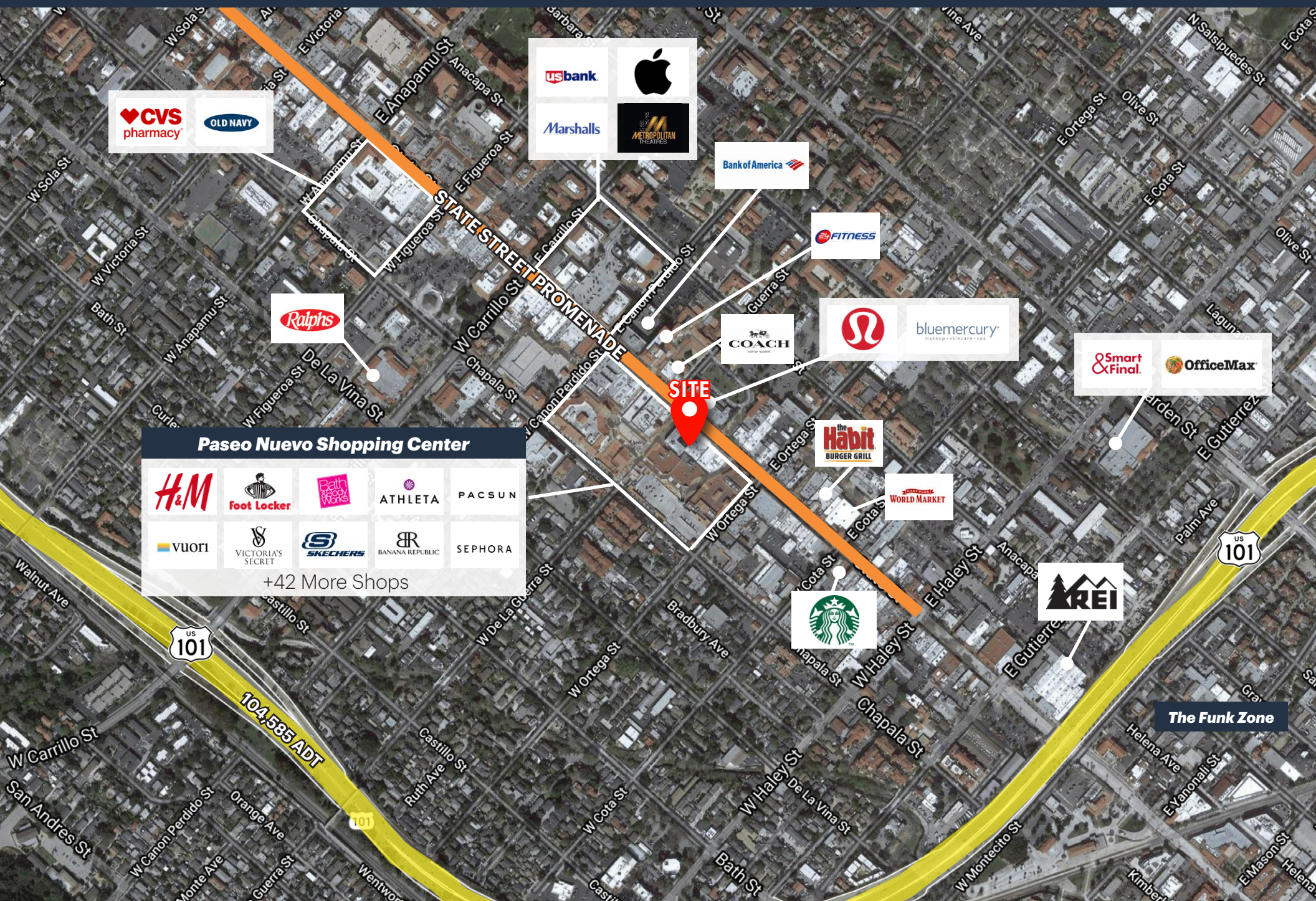

CLOSE-UP AERIAL



DEMOGRAPHICS

733 STATE STREET
SANTA BARBARA, CA



POPULATION

1 MILE	3 MILES	5 MILES
26,292	87,005	107,882



ESTIMATED HOUSEHOLDS

1 MILE	3 MILES	5 MILES
10,753	34,607	43,316



ESTIMATED AVERAGE HOUSEHOLD INCOME

1 MILE	3 MILES	5 MILES
\$124,495	\$178,921	\$188,938



ESTIMATED AVERAGE HOUSEHOLD NET WORTH

1 MILE	3 MILES	5 MILES
\$1.21 M	\$1.67 M	\$1.71 M



COLLEGE DEGREE BACHELOR DEGREE OR HIGHER

1 MILE	3 MILES	5 MILES
40.1%	51.4%	53.1%



TOTAL RETAIL EXPENDITURES

1 MILE	3 MILES	5 MILES
\$413.74 M	\$1.76 B	\$2.31 B

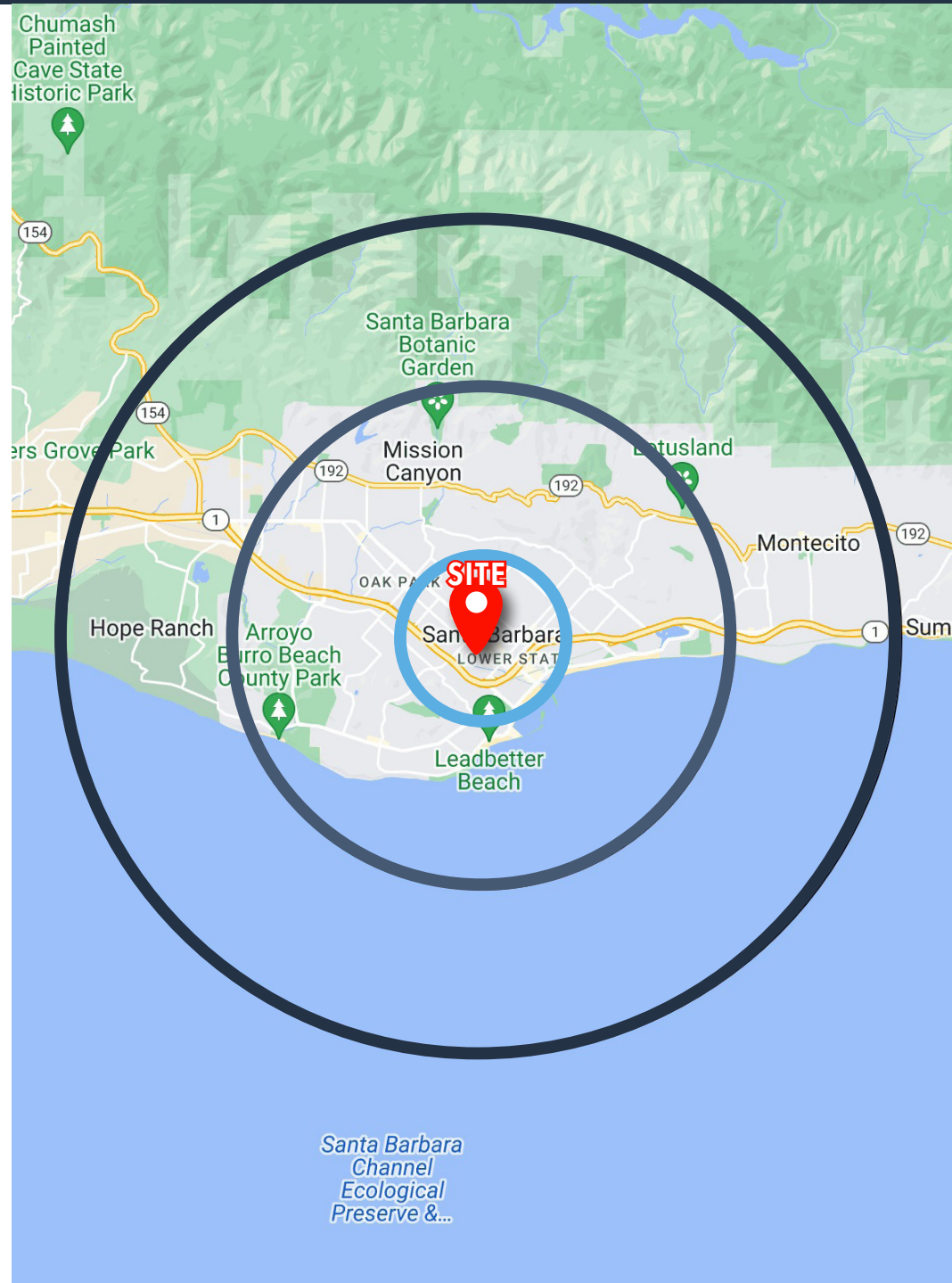

DOWNTOWN SANTA BARBARA



Downtown Santa Barbara is one of America's most pedestrian-friendly downtowns in large part to the diversity of shopping, food and beverage and scenery. The shop-lined streets are a favorite with visitors and locals alike. From Santa Barbara-style specialty shops to national brands, and from regional gallery favorites to indie boutiques, Downtown Santa Barbara offers an authentic experience for all to enjoy.



Over 7 million tourists visit the Santa Barbara area annually.



Over \$2 Billion in Retail Expenditures in 2022.



Roughly 70% of retail expenditures are on traditional retail shopping and 30% on food and beverage.