

FOR LEASE

**16,000 ft² Freestanding Flagship
Retail Building With Exclusive Parking**

PLEASE DO NOT DISTURB CURRENT TENANT



5800 Christie Avenue, Emeryville, CA



CHRIS HOMS
(650) 548-2687
Chris@lockehouse.com
License #01901922

NICK SCHMIDTER
(650) 548-2667
Nick@lockehouse.com
License #01801511

BRENDAN WALSH
(925) 627-4272
Brendan@lockehouse.com
License #02140273

PROPERTY HIGHLIGHTS

5800 Christie Avenue, Emeryville, CA



SUMMARY

ADDRESS	5800 Christie Avenue, Emeryville, CA 94608
COUNTY	Alameda County
AVAILABLE	Immediately
RENT	Call to Inquire
NNN	Call to Inquire
TRAFFIC COUNTS	Powell St. - 28,311 ADT Christie Ave. - 11,776 ADT

PROPERTY PROFILE

AVAILABLE SPACE

16,000 SF

PROPERTY HIGHLIGHTS

- Single Tenant Property
- High Identity Location
- Signalized Intersection
- Interstate 80 Visibility
- 33 Exclusive Parking Stalls
- At-Grade Loading Dock
- Exceptional Signage
- Turn-Key Condition



PLEASE DO NOT DISTURB CURRENT TENANT

FLOOR PLAN

5800 Christie Avenue, Emeryville, CA

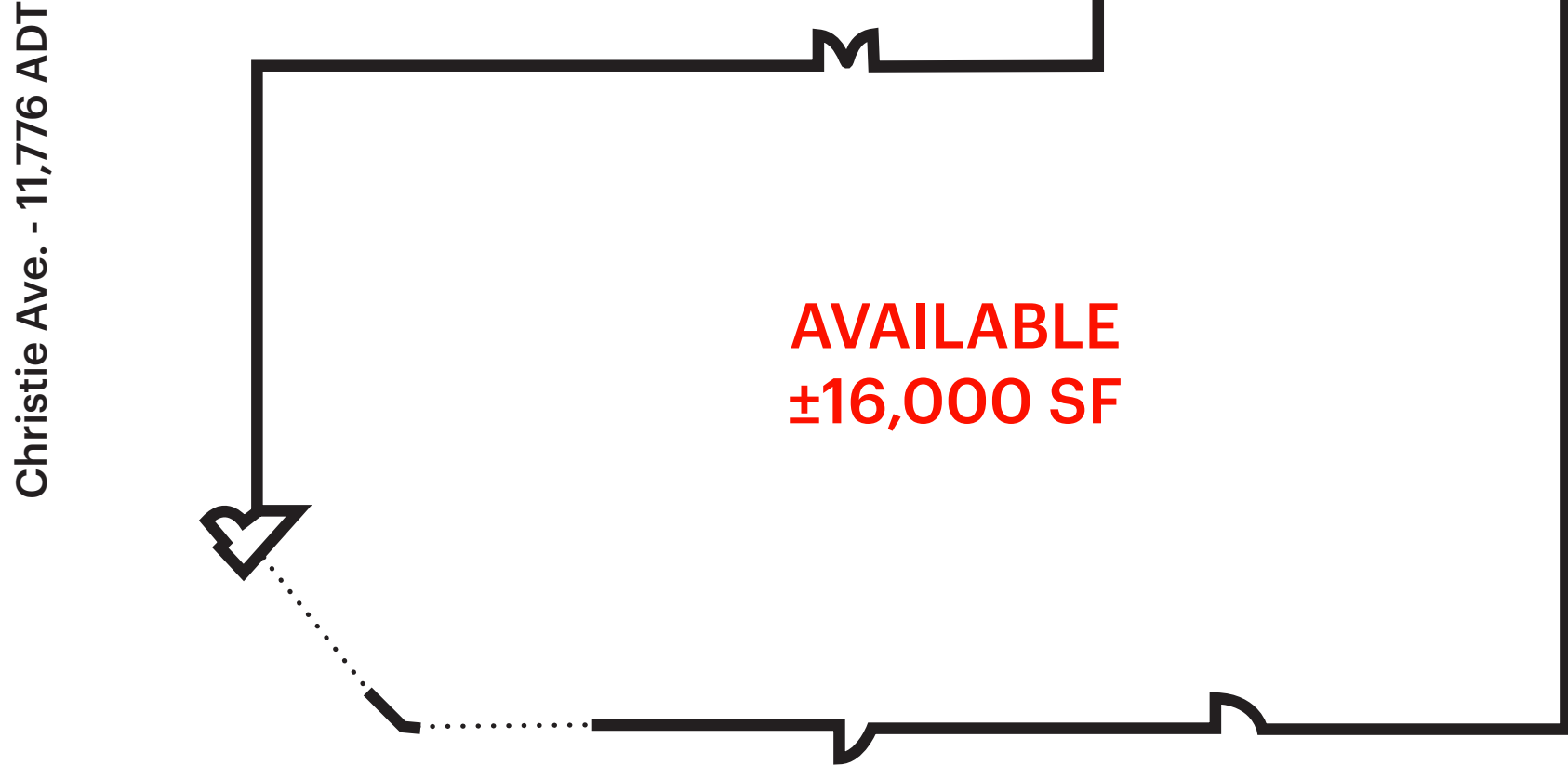

BIRD'S EYE VIEW

5800 Christie Avenue, Emeryville, CA



BAY STREET

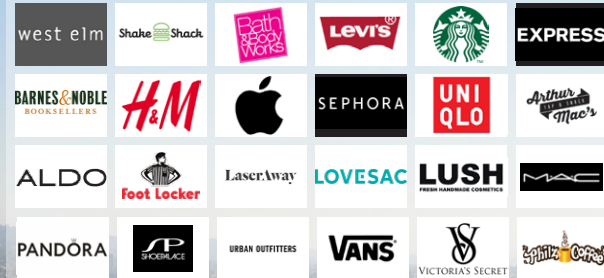

EAST BAY BRIDGE

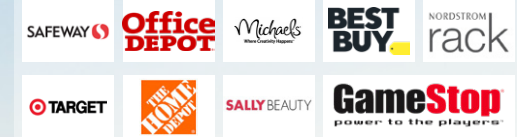

POWELL STREET PLAZA



SITE

POWELL ST. - 28,311 ADT

285,575 ADT



CLOSE-UP AERIAL

5800 Christie Avenue, Emeryville, CA



PUBLIC MARKET



POWELL STREET PLAZA

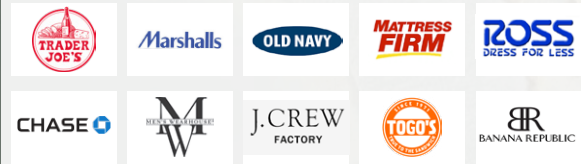

BAY STREET

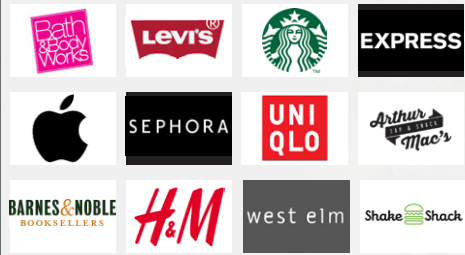

EAST BAY BRIDGE



MARKET AERIAL

5800 Christie Avenue, Emeryville, CA



DEMOGRAPHICS

5800 Christie Avenue, Emeryville, CA

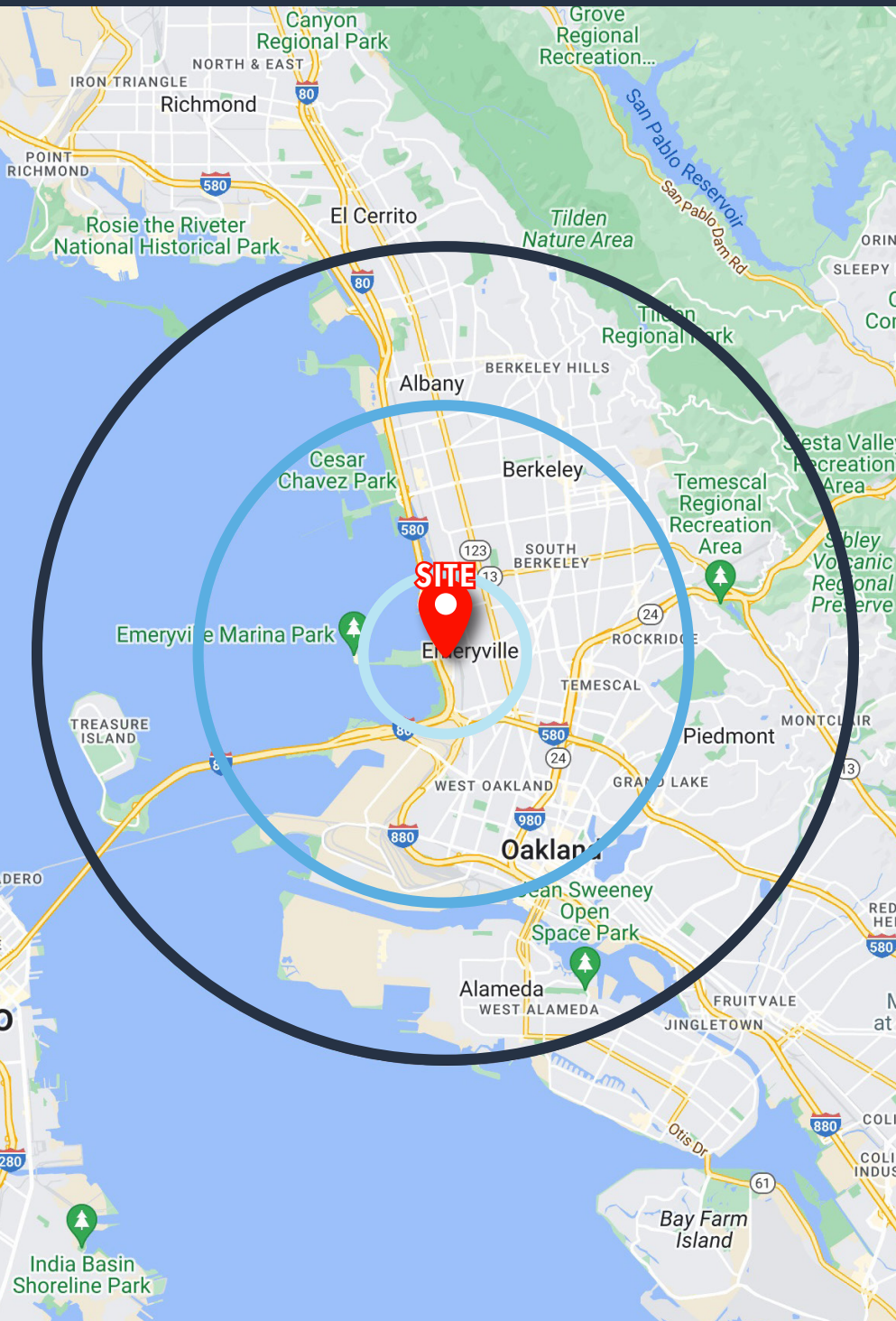

1 MILES	3 MILES	5 MILES
19,045	230,404	428,447

**ESTIMATED
POPULATION**



1 MILES	3 MILES	5 MILES
25,934	220,415	345,058

**DAYTIME
EMPLOYEES**



1 MILES	3 MILES	5 MILES
\$178,499	\$148,294	\$173,186

**AVERAGE
HOUSEHOLD
INCOME**



1 MILES	3 MILES	5 MILES
66.5%	64.2%	64.4%

**BACHELOR'S
DEGREE OR
HIGHER**



1 MILES	3 MILES	5 MILES
\$475.27 M	\$4.51 B	\$9.09 B

**HOUSEHOLD
RETAIL
EXPENDITURES**



1 MILES	3 MILES	5 MILES
6.4%	8.8%	11.4%

**HOUSEHOLDS
WITH CHILDREN**



1 MILES	3 MILES	5 MILES
36.1%	48.9%	52.2%

**HOME VALUES
OVER 1 MILLION**

